



INTERIOR DESIGN

DKA

CREATING ENVIRONMENTS THAT ENHANCE THE USER EXPERIENCE

Good interior design has the ability to increase both the functionality and enjoyment of a space. Placing users needs first, our designers tools include materials, form, texture, colour and ergonomic principles to make buildings work better. We find pleasure in the details and junctions, comfort in the furniture and familiarity in colours and wayfinding. For users with additional needs, interior design can play a huge part in allowing them to make sense of their environment, achieve greater independence and help their emotional wellbeing.

WHY DKA?

Interior design plays a role in all our building projects, from initial space planning through to the selection of internal materials and bespoke fixtures and fittings. A strong interior scheme has the power to transform a space; increasing functionality and commercial value as well as providing the right look and feel.

We use environmental psychology principles to guide our interior design ethos. We aim to provide designs that positively impact a users wellbeing, whether that be through access to nature and light, the provision of varied settings or by increasing accessibility and opportunities for independence. It's important that we work closely with clients and users to fully understand their needs and aspirations. We work across all sectors, with each project feeding back valuable lessons that are applied in the next - from the needs of a student in an ASD school to staff working in STEM subjects.

We are used to working in commercial environments where materials and colour selection help to enforce branding and work with suppliers to ensure the brand guidance is followed, whilst respecting the needs for confidentiality and good value. We produce designs in BIM, allowing us to generate 3D renders and consider schemes from every angle. This helps our clients to visualise the interiors and choose options based on both computer-generated views and physical samples. Working in BIM also allows us to easily output schedules and finishes drawings for contractors and suppliers.

We keep abreast of the latest industry trends and innovations so we can be sure our projects remain fresh and offer best value. We appreciate the dual demands of practicality (cleaning, maintenance) alongside visual impact. The way we coordinate this with our core architectural service gives the client a complete design that is both functional and attractive.

SERVICES

Our interior design service covers full interior design schemes, concept renders, furniture and fittings schedules, bespoke furniture design, mood boards, reception spaces / desks, dining and catering environments, workspace analysis, dementia-friendly design, designing for autism, inclusive design, art strategies, styling of communal spaces and show apartments, design strategy documents and post-occupancy evaluations. We can advise on the necessary surveys and specialist consultants. We can act as Principal Designer for CDM 2015.



UNIVERSITY OF BRISTOL QUEEN'S BUILDING REFURBISHMENT

ATTRACTING THE NEXT GENERATION OF ENGINEERS

For our first project at the University of Bristol, the brief for Queen's Building was to reconfigure and refurbish the main entrance and adjacent wings to provide modern accommodation that meets the expectations of students attending a world-leading engineering faculty. The new facilities include: a café; student study rooms; faculty offices and hand-in spaces; laboratories; and improved (and more inclusive) welfare facilities.

During an intensive pre-construction phase, we engaged widely with key university stakeholders to capture the brief and incorporate applicable university standards. Modelling the scheme in Revit, we coordinated our architectural layouts and interior design concepts, created furniture schedules and finishes boards for sign off. Room Data Sheets, also created from the model, acted as the key point of reference with architecture, M&E and all fittings clearly identified.

References to engineering are included in materials used throughout the scheme. The revitalised main entrance is particularly successful; original timber panelling and stone-faced walls are retained alongside a welcoming new reception area, including a showcase feature wall displaying typical engineering materials suggested by the client team.

The café and student study rooms provide a variety of seating areas for meeting and eating and enjoy 24-hour access by students. Large existing windows on the north elevation provide excellent light to the space and the high ceilings give the room a bright airy feel. The 24 hour access also provided us with some interesting design considerations, as we were assured that students can be a little mischievous when left to their own devices!

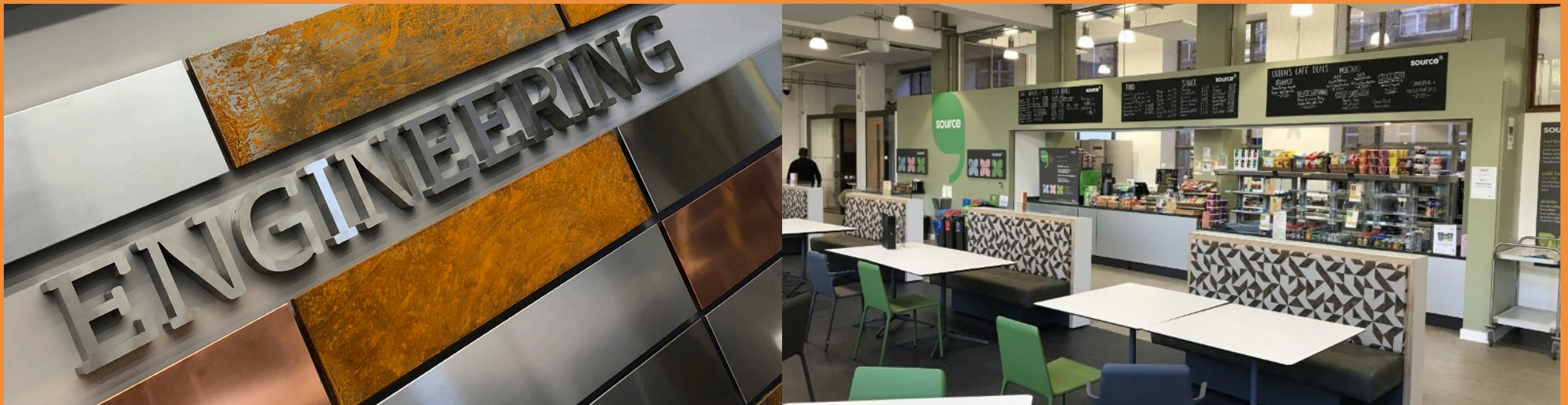

NEEDHAM HOUSE

SETTING THE SCENE FOR AN INDEPENDENT RETIREMENT

Following our work on the Dementia Design Strategy for Bridgwater Hospital, we were approached by Wiltshire Council to bring their 'Design Guide for Extra Care Housing' in line with current guidance. This set out the requirements for future developments and was designed to inform all members of the team about the importance of various design features to the wellbeing of future residents.

The following year we were able to put the Design Guide into practice at Needham House, Devizes, the first Extra Care scheme built by Wiltshire Council to provide purpose-designed housing for over 55s. Designed to HAPPI principles, the 47-apartment development also houses a communal lounge, dining room and activity rooms. The interior is designed to promote a sense of community and interaction between residents – from the colour zoning of each 'neighbourhood' to the widening internal 'streets' that give residents space to stop and chat with each other as they move through the building.

Finishes have been chosen with residents' wellbeing and long-term practicality in mind. Warm natural finishes and soft flooring help to create a homely feel, careful use of contrast aids those who are partially-sighted and slip-resistant surfaces without obvious thresholds help to avoid falls. We also worked closely with the Council's FM and maintenance departments to ensure they were happy they could easily maintain the building, without sacrificing style and comfort for residents.

The show home was fully fitted-out and dressed by DKA to illustrate that specialist housing does not have to feel institutional and it reflects the lifestyle many of us hope we will be able to enjoy in our retirement. We thoroughly enjoyed seeing the finishing touches bring it all together – even getting our hands dirty planting up the garden troughs!



BBC THREE COUNTIES

INNOVATIVE WORKSPACE DESIGN, REINFORCING BRAND ETHOS

This brief required a new radio station within an existing retail unit in Dunstable. When we first met with the Editor of BBC Three Counties Radio we were given our brief in two parts. The first was the technical brief, driven largely by BBC Standards used across all local radio stations. Compliance with this part of the brief would be relatively simple; provide this number of rooms at these sizes with a given technical performance.

The second part of the brief was less easily defined; it required the building to embody the values of the station, reach out to the listeners and create an environment to get the best out of the station team. That was our challenge as designers.

Our first option was based on the standard BBC model, with the studios at one end, opening onto a large open-plan newsroom. The second option placed the studios centrally in the space, reflecting their position at the heart of the operation. This central location also helped to split the remaining double height space in two, giving the newsroom separation from a flexible open space on the other side. By disregarding the standard model, the studios became a special object that made an impact, creating energy and intrigue.

The stakeholders were totally bowled over by Option 2. It was a totally unexpected, radical design. At an instant, they could see how it would change their working patterns for the better. Most of all, it made best use of the existing shell, displaying a fun and creative interior without being ostentatious or inflexible. An internal window allowed a view into the studio for the benefit of viewers and presenters alike.

By picking the unconventional approach they took a leap of faith in us as designers to deliver an exciting space along with the technical performance. We are delighted to have repaid that trust with a facility that challenged our skills and has proven to exceed their expectations.



'THE HIVE' BRISTOL BRUNEL ACADEMY

WORKING TOGETHER, CREATING A BUZZ

DKA were asked to provide a concept scheme for the redevelopment of an under-used student 'Cyber Café' into a working lounge for teachers. It was designed to reflect the importance of staff welfare and gave them the space for large presentations and meetings, as well as more intimate space for group working at PCs or a catch-up over a coffee.

We proposed 'The Hive' as a concept that encapsulated the idea of coming together to work collaboratively and expressed this through the interior finishes, drawing on the shapes found in a natural hive structure. The design also had to consider the privacy implications of a large ventilation opening which connected the space to the upper floors, allowing students to look into the space from above.

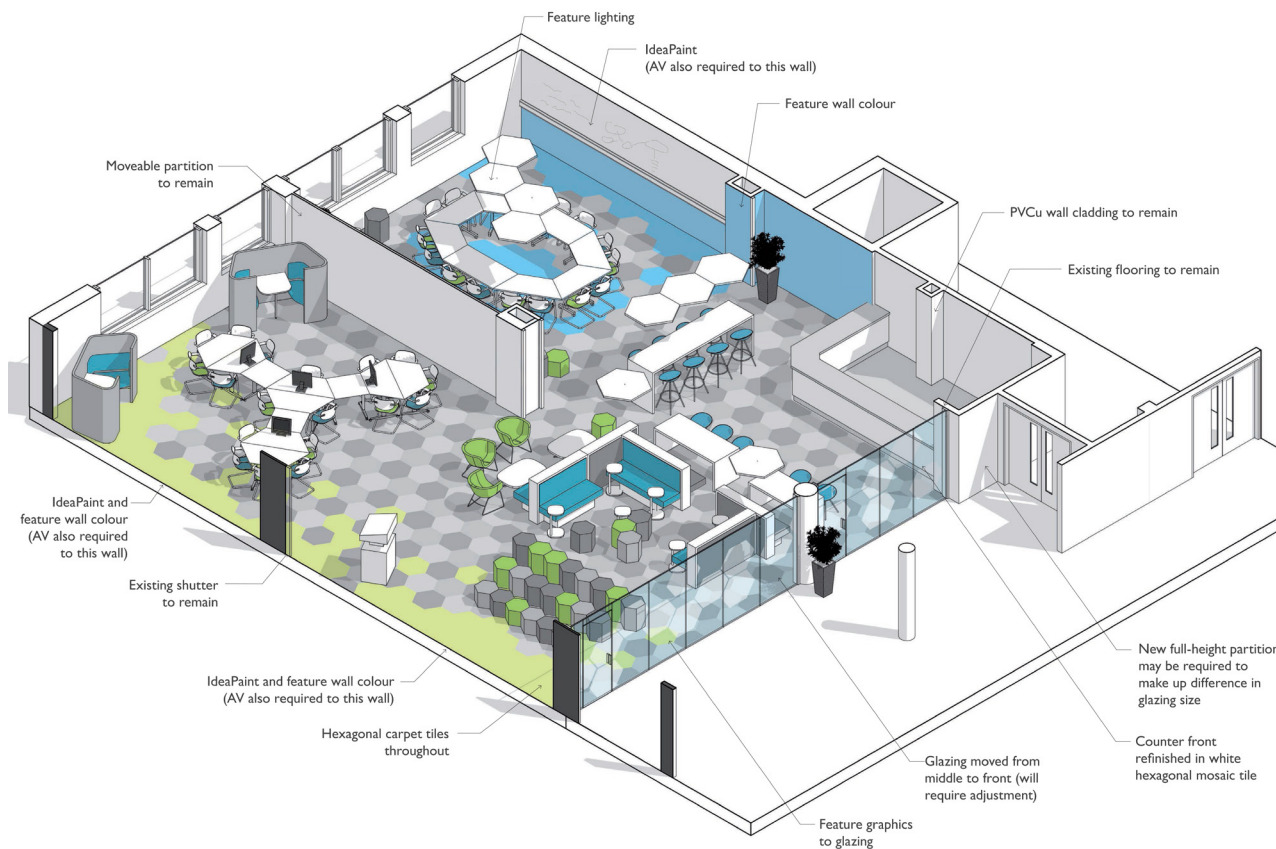

MONKTON PARK HUB

TRANSFORMING WAYS OF WORKING, GIVING THE HUB A NEW HEART

This was a fantastic opportunity to revisit a building we designed 12 years earlier, as a PFI-funded HQ for North Wiltshire District Council, and facilitate a county-wide change in how council services would be run in the future. The refurbishment for Wiltshire Council, was a vital part of its Workplace Transformation Programme, reducing an extraordinary 95 offices down to four main hubs. The brief for Monkton Park was to increase occupancy from 340 to 540 staff, whilst providing a modern flexible workplace. A full internal refurbishment called for new finishes, furniture and new kitchen spaces on each of the floors. The first hub at County Hall was already complete, so it was important to create a similar feel to reinforce the unified brand across the hubs.

Wiltshire Council were moving towards higher levels of home-working and hot-desking and with this came a need to create varied work settings. We carefully analysed proportions of space types and storage and worked through this with the client team to provide the ratio most suitable to their needs. Our designs created bridges at three levels to improve connectivity between floorplates while obeying desire lines (including routes to the WCs), housing new staff kitchens and breakout spaces. These spaces became the heart of each floor, facilitating casual interaction between colleagues from every part of the organisation.

The building had achieved BREEAM 'Excellent' and featured in CABI's 'Better Places to Work', partly thanks to its use of natural ventilation and concrete coffer for thermal mass, so we worked hard to create a scheme that avoided the need to introduce mechanical ventilation. We designed the bridges as lightweight timber clad objects, mimicking the curves of the exposed concrete coffers. They appear like pieces of furniture, incorporating the lighting and kitchen services. Crucially, they do not block light from the atrium into the floor plates, nor disrupt the natural ventilation strategy. One simple intervention has transformed the offices and the working lives of the staff.

Construction was carried out floor-by-floor, which allowed staff to continue to use the building for the duration of the works. It was particularly important that the building remain operational, as the Police Service also operated from the hub and required 24 hour access.



STAFF RESTAURANT



EATING & MEETING

DKA provided architectural, interior design and lead consultant services for a major extension and refurbishment of a staff restaurant for a leading blue-chip client in the automotive engineering sector. The project formed part of site-wide improvements designed to attract and retain the best staff. An extension was built to house a new kitchen, with the old kitchen being refurbished to provide a new servery and seating area. The design incorporated a range of seating types, including luxurious leather-upholstered booths, to provide areas for informal meetings as well as additional dining space. The project has enhanced the quality of service and reduced queueing time, whilst doubling turnover. It is also a very pleasant space to meet in while discussing further projects at the site!

SPECULATIVE OFFICE REFURBS



CREATING A GREAT FIRST IMPRESSION

DKA were appointed by AEW(UK) to transform two outdated office buildings in Bristol. The projects included the complete internal strip out and replacement of the M&E systems, new finishes to office spaces, toilets, common areas and new receptions. Given the speculative nature of the developments, we were conscious that the design needed to be eye-catching, but not so bold that it might clash with the branding of potential occupants. Both schemes use predominantly neutral colours, with a variety of textures and materials adding interest.

OTHER PROJECTS

- GOVERNMENT DEPARTMENT HQ FIT-OUT, LONDON
- PUBLIC-FACING PROJECTS, MERCEDES-BENZ WORLD
- RECEPTION AND STAFF RESTAURANT, MERCEDES AMG TECHNOLOGY CENTRE
- COMMON ROOM REFURBISHMENT, BRIDGWATER COLLEGE
- LIBRARY REFURBISHMENT CONCEPTS, SHELDON SCHOOL
- CLUBHOUSE AND CARE HOME, AVONPARK RETIREMENT VILLAGE
- CLUBHOUSE AND CARE HOME, GITTISHAM HILL HOUSE
- CASTLE HOUSE CARE HOME
- BRIDGWATER HOSPITAL INTERIORS AND DEMENTIA STRATEGY
- WILTSHIRE COUNCIL EXTRA CARE DESIGN GUIDE AND SPECIFICATION GUIDE

KEY PEOPLE

ALEX BELL

*DIRECTOR - BSC (HONS) MARCH ARB RIBA,
RIBA CONSERVATION REGISTER (CR)*

Alex has worked at DKA since 2002, becoming a specialist in sustainable design, commercial and education projects. He qualified as an architect in 2004 and later as a BREEAM Assessor. Alex possesses a strong design awareness combined with a methodical approach to managing projects and teams. He loves to find alternative design solutions to add value to a project.

alex.bell@dka.co.uk



REBECCA FURSE

*SENIOR DESIGNER - BA (HONS) MSc ENVIRONMENTAL PSYCHOLOGY
AUTODESK® CERTIFIED PROFESSIONAL; DEMENTIA FRIEND*

Rebecca joined DKA in 2007 and has worked across all sectors, initially in a technical capacity and now leading our interiors team. Her understanding of environmental psychology principles and experience working in the healthcare team make her highly aware of the impact good design can have, whether it's in achieving independence with a disability or simply having a pleasant and efficient environment to work in. Rebecca has excellent contacts with furniture and finishes suppliers and coordinates these into all the projects she works on.

rebecca.furse@dka.co.uk



www.dka.co.uk | The Malt House, 17-20 Sydney Buildings, Bath BA2 6BZ

01225 465 701 | info@dka.co.uk | Rev B 23.02.18

ABOUT DKA

We apply our design vision and technical expertise to create buildings that are expertly designed, carefully resourced and robustly built.

A firm built on reputation and referral, we are a Bath based independent architectural practice celebrating a proud 25-year history based on quality and relationships.

We pride ourselves on being reliable, personable and professional experts in our respective fields across a multi-sector portfolio of work including residential, commercial, education, healthcare, engineering and defence ranging in size from £0.5m to £50m.

We are an ISO9001 registered practice offering architectural services, master planning, interior design, project management, BIM management and design co-ordination services.

DKA understand that good design must stand the test of time, so for a short time we, as architects, are custodians of the future creating the foundations for the societies of tomorrow.

We look forward to working with you on your next project.

DKA: DESIGNING THE FUTURE, TODAY